

5.1 West Deeping

LINCOLNSHIRE COUNTY COUNCIL
 PLANNING AND REGULATION COMMITTEE 4 JULY 2022

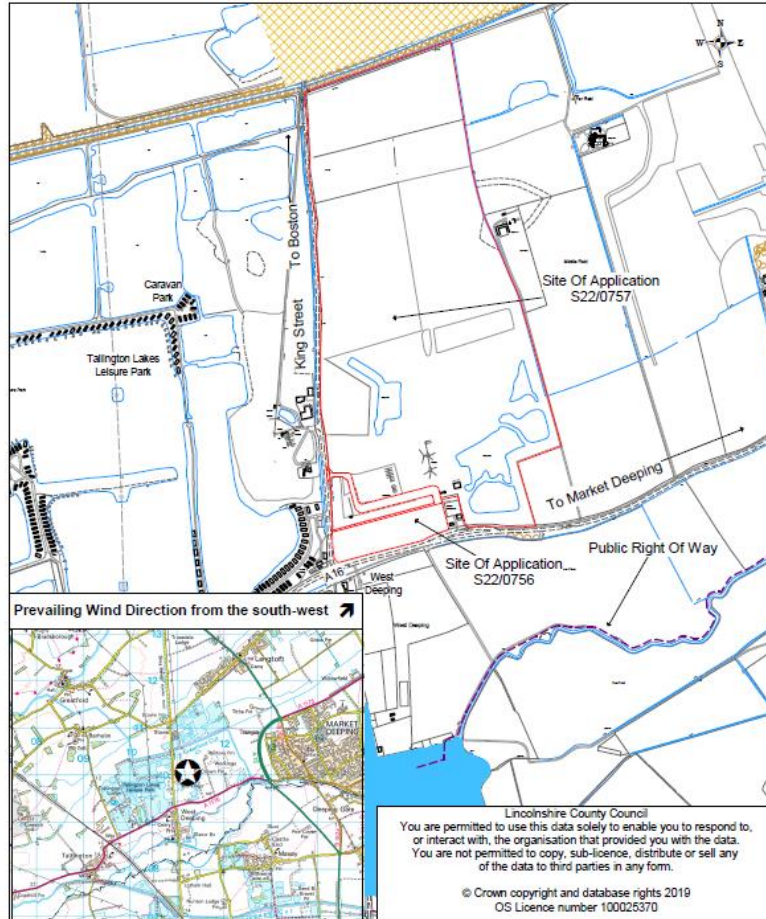

Location:
 West Deeping Quarry
 King Street
 West Deeping

Application Nos: S22/0756 & S22/0757
Scale: 1:10000

Description:

For the proposed southern extension to existing sand and gravel extraction operations with restoration to low level agriculture and amenity/nature conservation

To vary conditions 2 and 4 of planning permission S19/2127

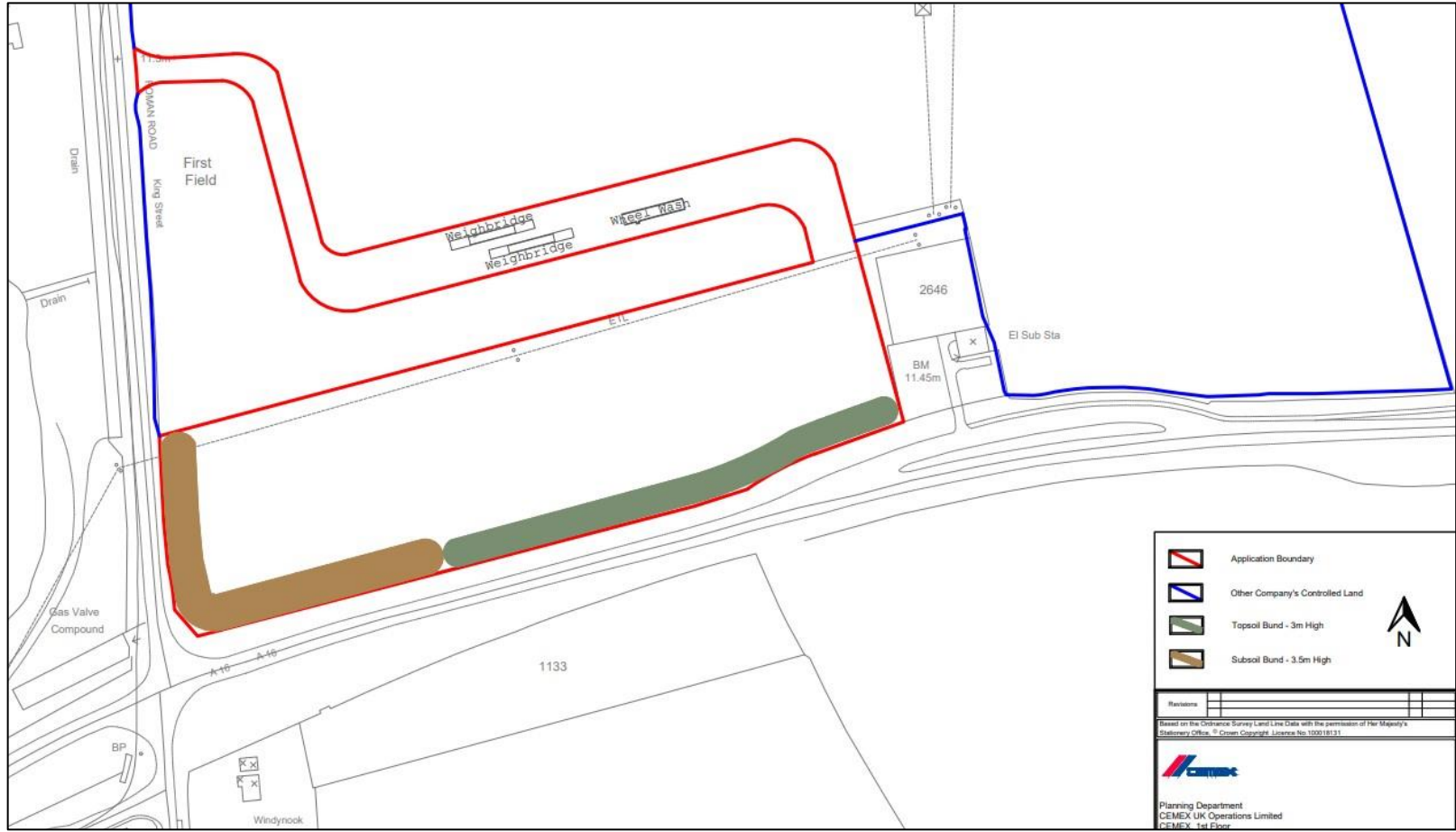

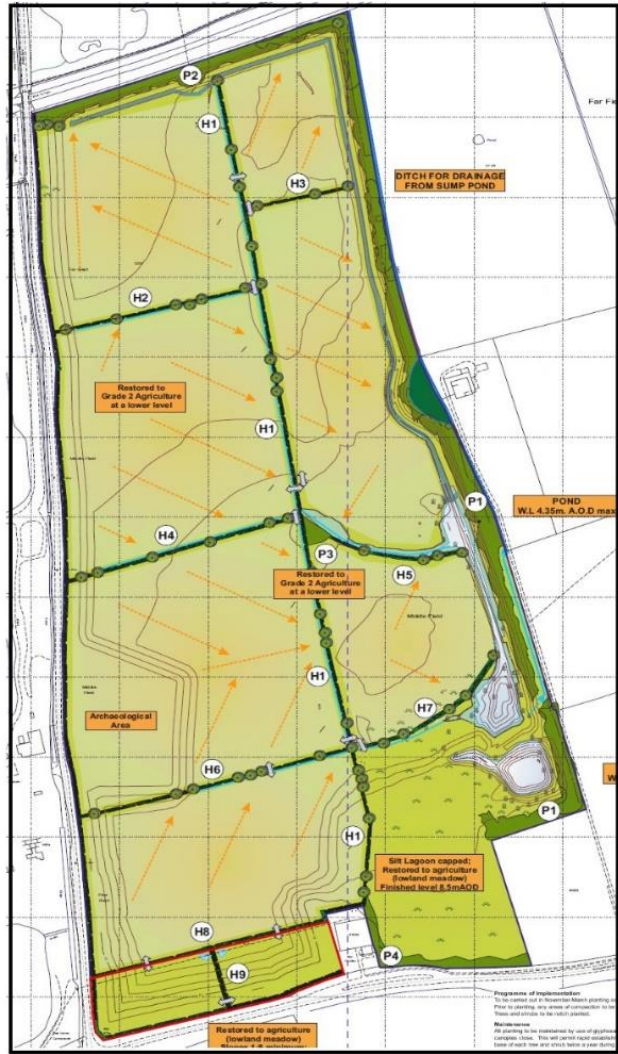
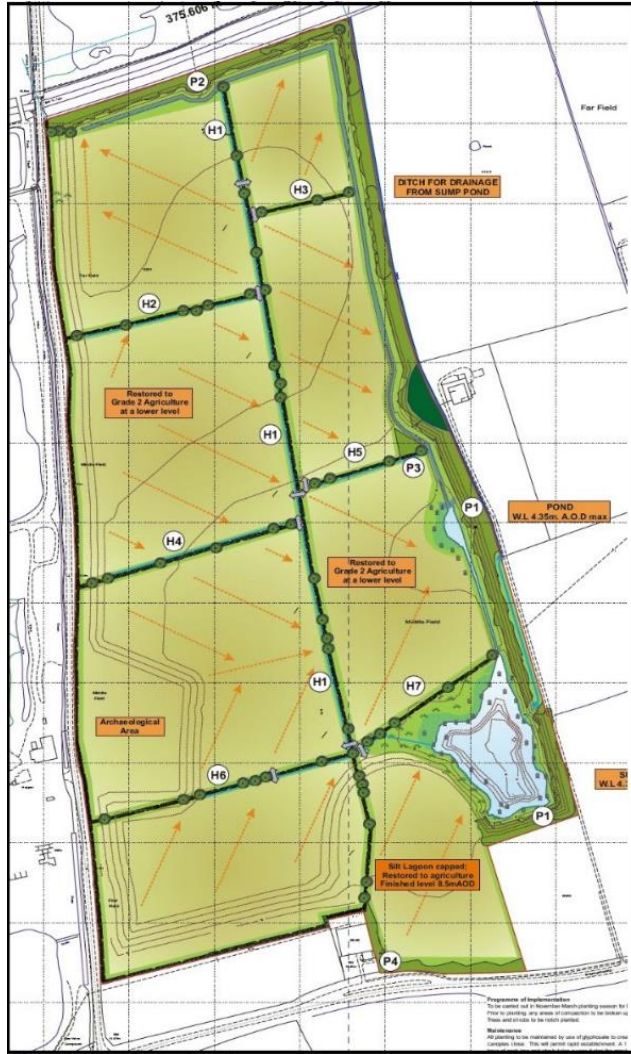

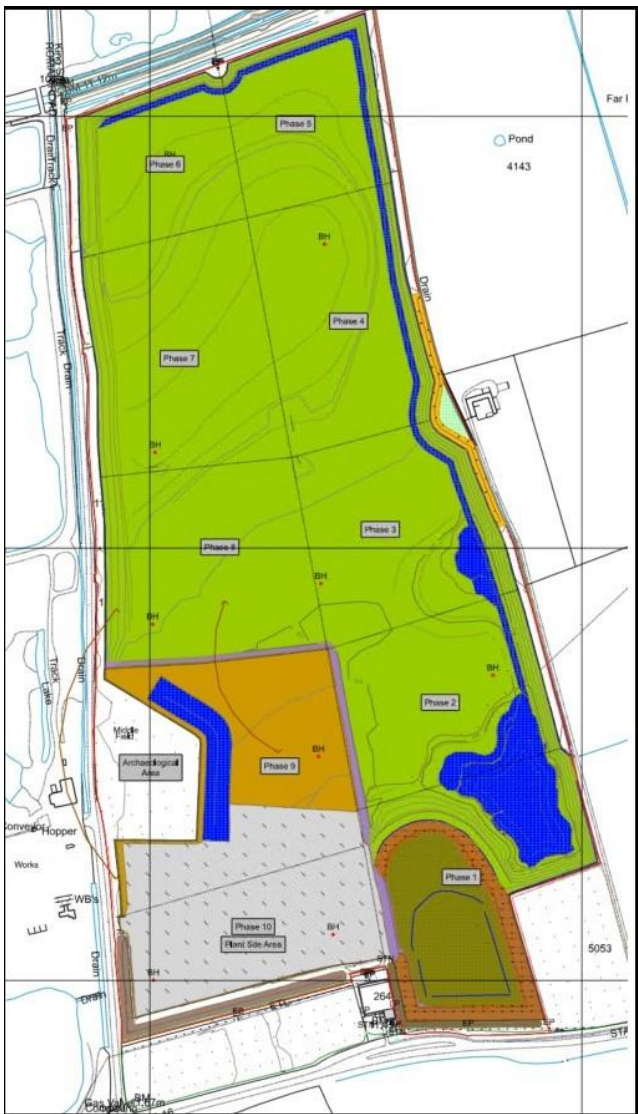





5.2 Baston

LINCOLNSHIRE COUNTY COUNCIL
PLANNING AND REGULATION COMMITTEE 4 JULY 2022

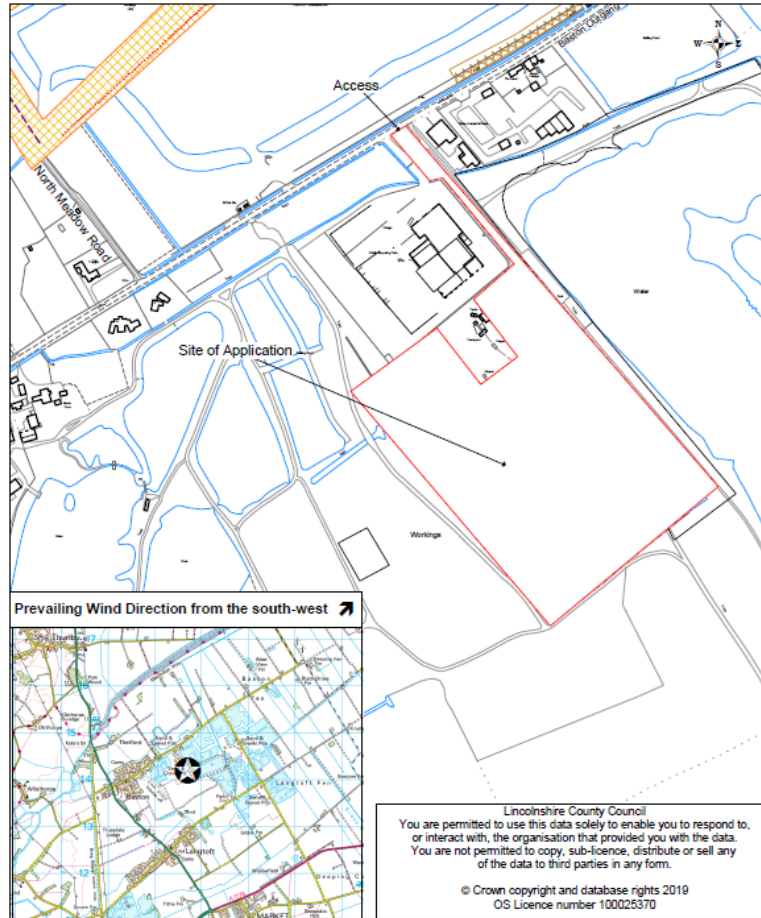

Location:
Manor Pit
Baston Outgang Road
Baston

Application No: S22/0758
Scale: 1:5000

Description:
For the extraction of sand and gravel beneath former plant site with enhanced restoration to amenity/nature conservation

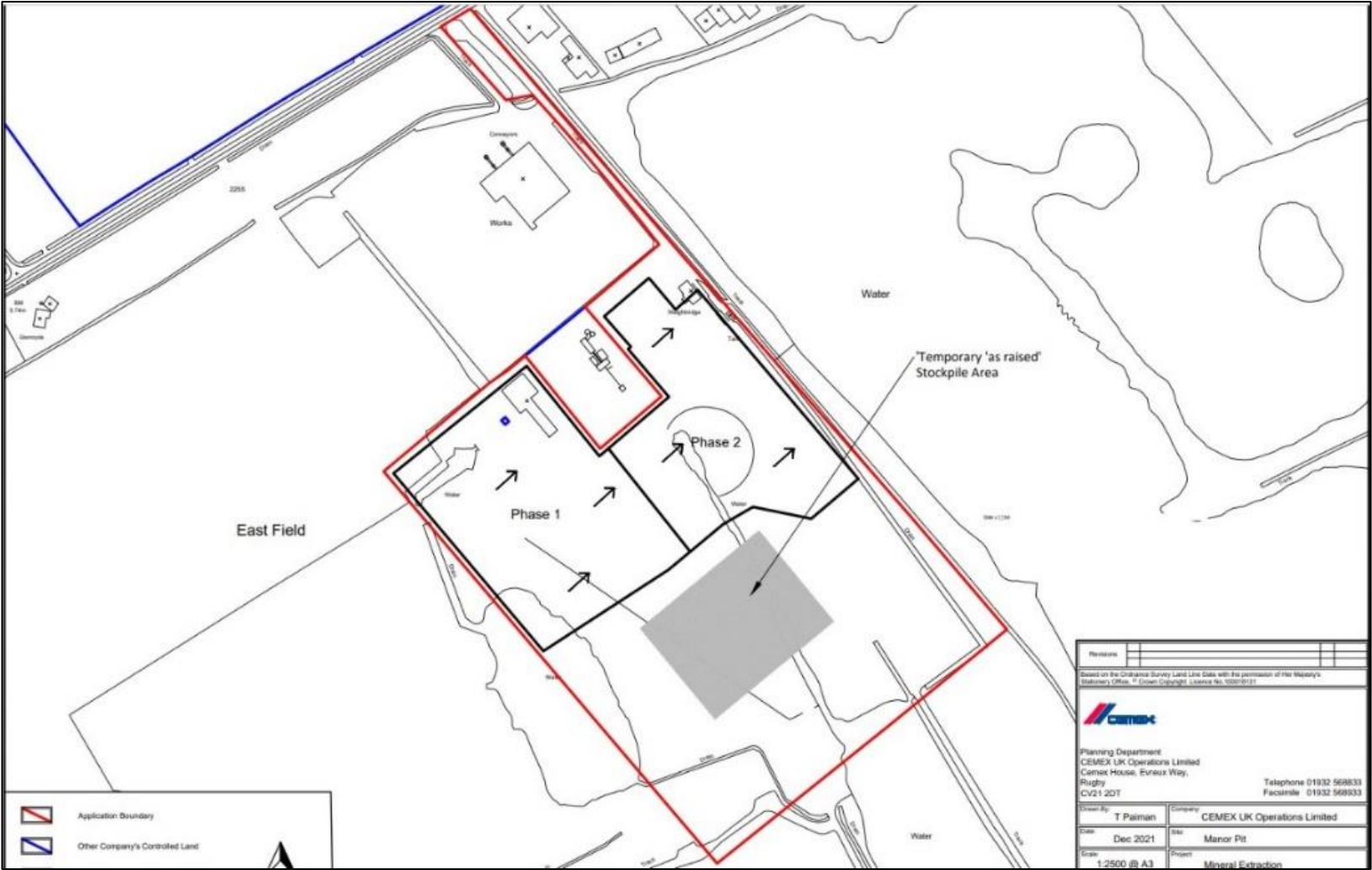

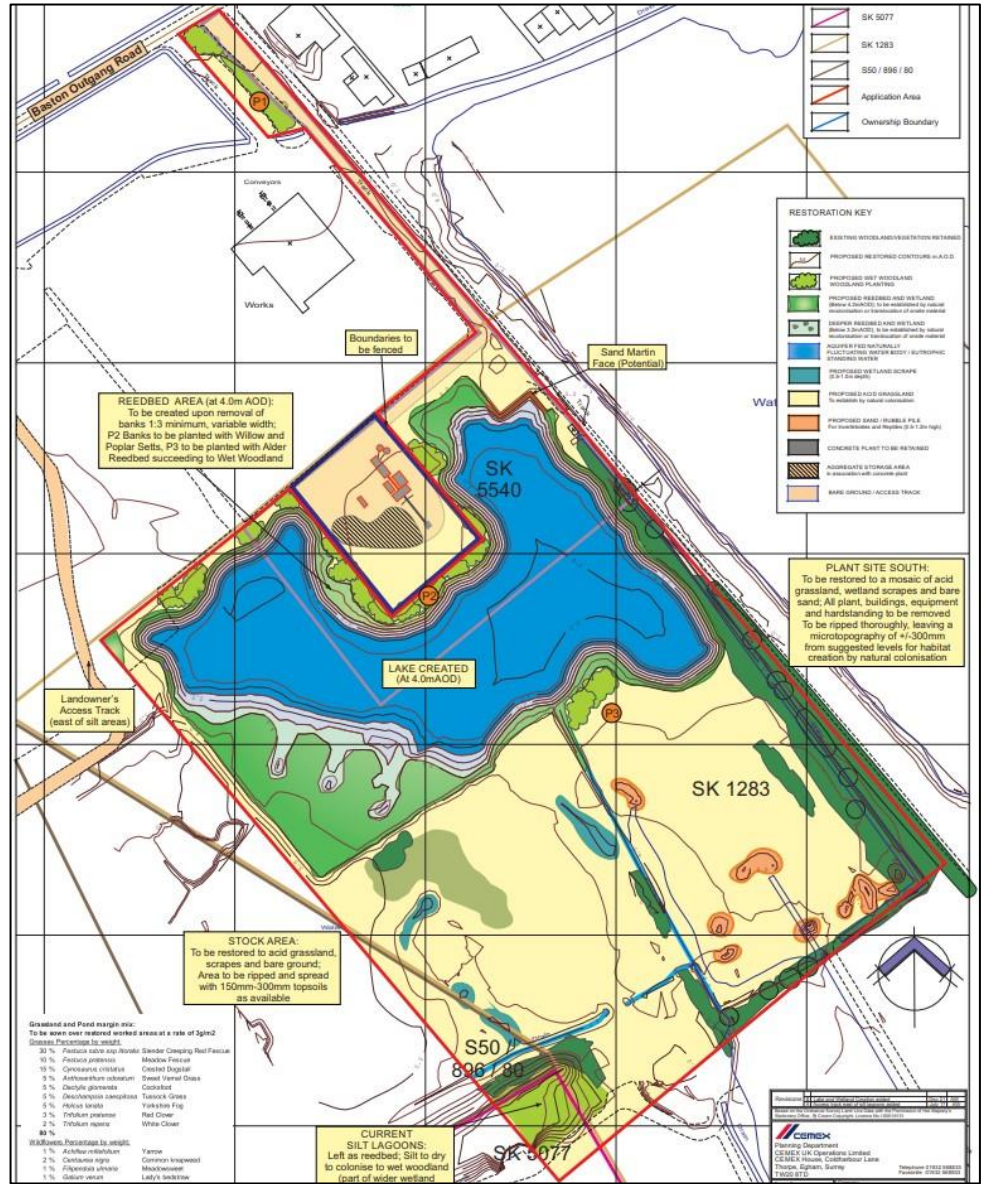





5.3 West Deeping

